

## AP MODULAR PIPING SYSTEM

This product patented by Teseo is the result of years of research and experience in installing thousands of distribution systems made up of aluminium profiles all over the world. AP is suitable for compressed air distribution lines or for main line drops.

### The following advantages stand out:

- Easy and quick to assemble, no special tools required, it can be assembled without special skills.
- Its simple section is symmetric and can be used on all the sides. Easy to cut and bend.
- Equipped with numerous accessories which are designed of simple modular elements compatible both with the present HBS system and steel pipes with "Gas" BSP or NPT threads.
- A very competitive price, thanks to the quick mounting, AP is more convenient than a traditional piping system.

### EASY TO ASSEMBLE

#### DEBURRING



#### MOUNTING



#### ASSEMBLING



#### TIGHTENING

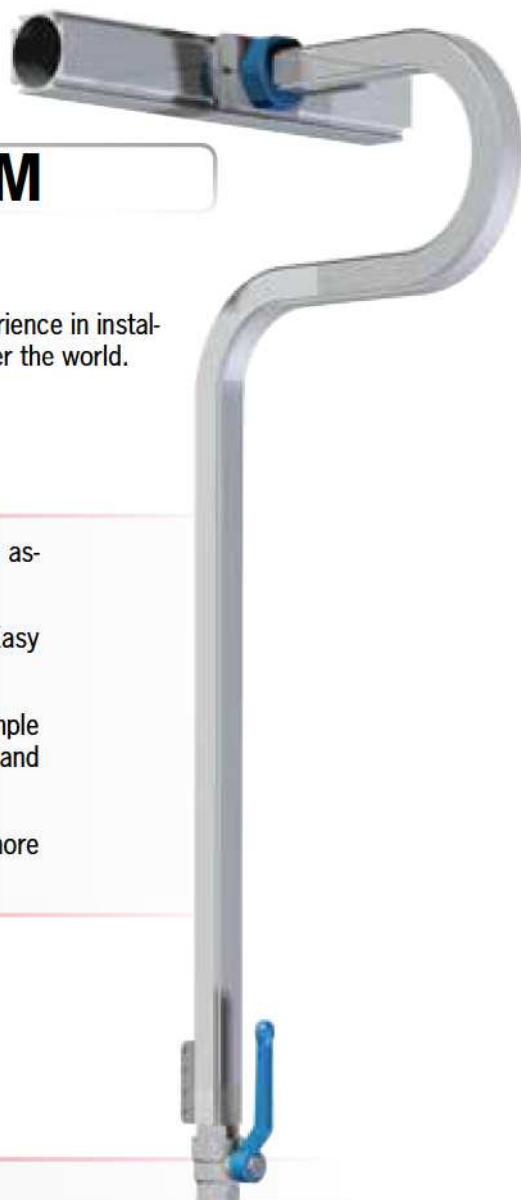

## BLUE DESIGN

The new generation of "blue" in **TESEO** is the result of the modification and the improvement of all the Teseo systems. Our continuous research into **Energy Saving** together with a high regard for the **Design** ruled our technical choices. We studied the internal passages and the thicknesses to increase the flow rate.

**Double seats for the O-rings** and high quality **NBR Blue O-Rings**, manufactured for Teseo, are applied to all the connections for a better sealing.

**Ergonomics** of the complete system has been improved thanks to optimization of the shapes and weights. Precision manufacturing carried out on many components improves the outer finishing and removes the die-casting defects.

**Outlet plates** have been re designed with new moulds, to improve quality and accuracy. The blocking parts have been analyzed and improved.

**The implementation** of accessories and components is continuous.

Teseo are sourcing **New certifications** and international confirmation.



Indicative diagram for the choice of the AP diameter according to compressor installed max power

Compressor power	AP	Indicative flow rate (L 30m - 6 bar - Δp 3%)
kW		l/min
11	22	1.650
19	28	2.900
36	36	5.400
67	45	10.000
110	54	16.400
195	68	29.200



Indicative diagrams of compressed air flow rates and related pressure drops in a line 30 m long (20°C - 1013 mbar). The data used has been provided by the POLYTECHNIC INSTITUTE OF TURIN.

See online software (page 9)

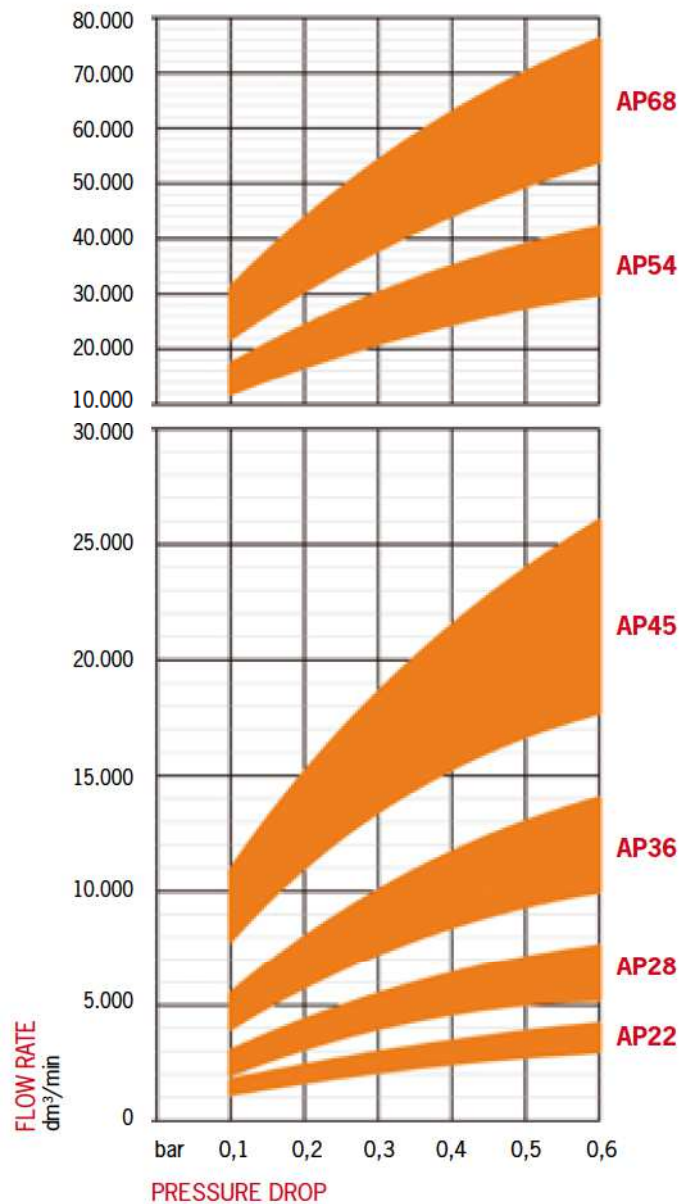

AIR PRESSURE: 6 → 12 bar  
 0,6 → 1,2 MPa  
 87 → 174 psi

AP

## TECHNICAL CHARACTERISTICS

Extruded Aluminium.....	<b>Alloy EN AW 6060 UNI EN 573-3:1996</b>
International designations.....	<b>ANSI 6060 - DIN 1748/1: AlMgSi 0,5 BS 6060</b>
Chemical composition.....	<b>Si: 0,45% - Mg: 0,45% - Fe: 0,3%</b>
Heat treatment.....	<b>Aging T5 o T6</b>
Surface treatment (upon request) .....	<b>Chemical silver anodization</b>
Specific weight, density .....	<b>Kg/dm<sup>3</sup> 2,71</b>
Electrical conductivity .....	<b>% IACS 53</b>
Thermal Conductivity .....	<b>W/m.K 200</b>
Specific heat.....	<b>J/Kg.K 96</b>
Coefficient of expansion.....	<b>mm/m °C 0,024</b>
Tensile strength.....	<b>Kg/mm<sup>2</sup> 24</b>
Yield strength.....	<b>Kg/mm<sup>2</sup> 20</b>
Modulus of elasticity.....	<b>Kg/mm<sup>2</sup> 6.700</b>
Brinell hardness .....	<b>HB 70÷80</b>
Melting range .....	<b>°C 600-650</b>
O-ring material .....	<b>NBR 70</b>
Operating temperature .....	<b>°C -20/+120</b>
Screw material .....	<b>Steel Class 8.8</b>
M5 Screw driving torque.....	<b>10 N·m (90 Inch·Lbs) ± 10%</b>
M6 Screw driving torque.....	<b>14 N·m (120 Inch·Lbs) ± 10%</b>
Outlet thread.....	<b>BSP or NPT</b>
Terminal thread .....	<b>BSP or NPT</b>
Max operating pressure .....	<b>15 bar - 1,5 MPa - 217 psi</b>
Powering multfluid, max operating pressure.....	<b>25 bar - 2,5 MPa - 362 psi</b>
Failure test pressure.....	<b>80 bar - 8 MPa - 1160 psi</b>

### Compatibility with fluids

Compressed air, Vacuum, Argon, Nitrogen, Carbon dioxide, Mineral oil\*, Synthetic oil\*, Other fluids\*

### WARNING!

Teseo components are intended only to uses for which they have been specifically designed by the manufacturer and patent holder. This does not absolve the professional user to refrain from checking technical compatibility and current project of your application. Our technical department is at your disposal for evaluations, analysis of special use, to design and eventually implement specific components and assemblies. Teseo company is not responsible for any damage caused by improper, erroneous, unreasonable and product incompatibilities with applications not specified by the catalog.

\*For further information, please apply to Teseo Srl Technical Office.

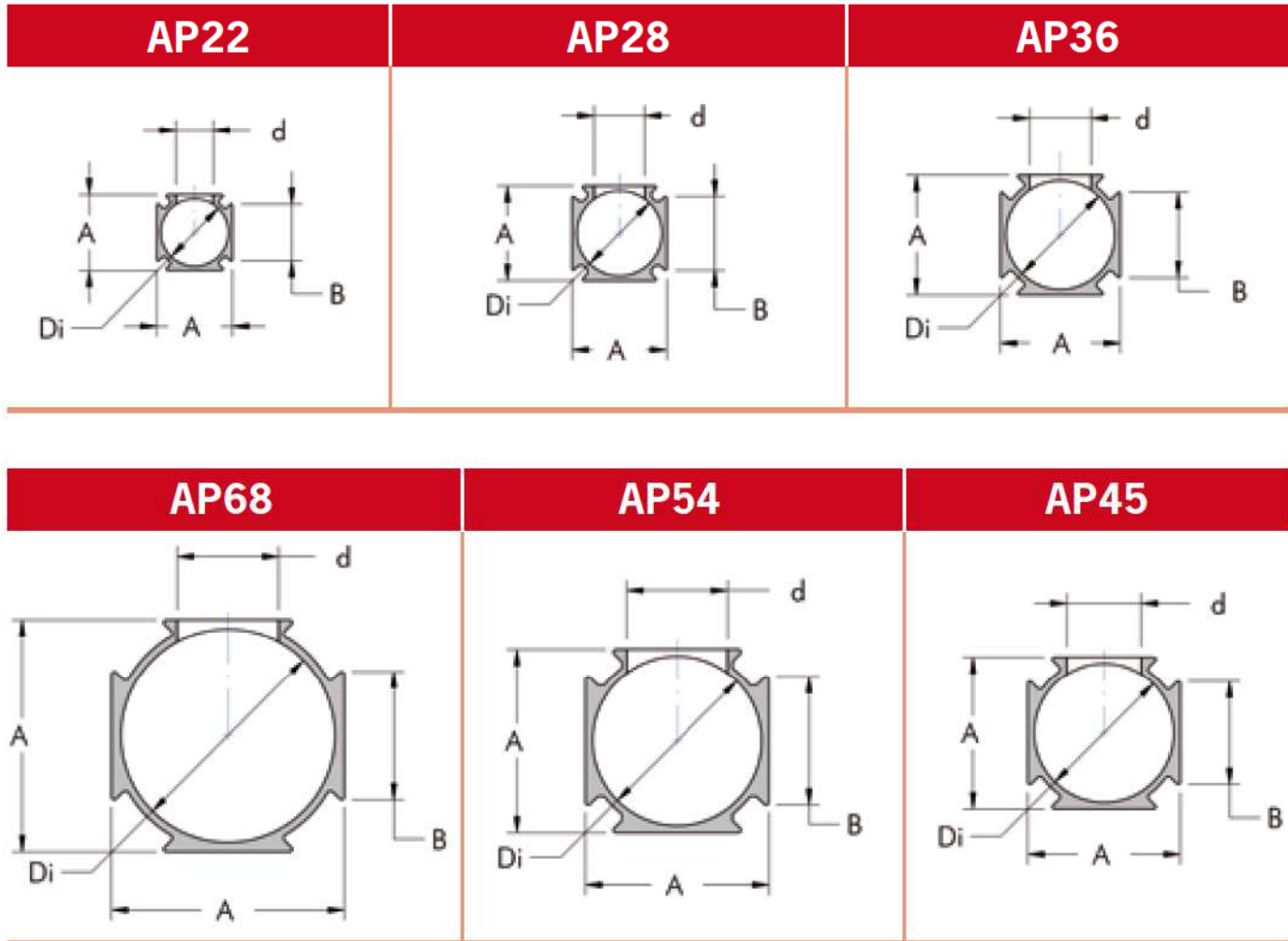
**PROFILES SECTION OVER VIEW**

AP

**SIZE DIMENSIONS**

Name	Dimensions				Max hole	Weight	Moment of inertia		Inner volume
	Di mm	A mm	B mm	d mm			Jx cm <sup>4</sup>	Jy cm <sup>4</sup>	
AP22	20	22,4	16,4	11	370	0,90	0,90	0,32	
AP28	25	28	21,5	15	590	2,20	2,20	0,5	
AP36	32	36	25	18	780	4,60	4,60	0,8	
AP45	40	45	31	22	1170	11,00	11,00	1,3	
AP54	50	55	38	30	1690	23,70	23,70	2	
AP68	63	69	38	30	2080	44,10	44,10	3,1	

## NATURAL ALUMINIUM EXTRUDED PIPE

POW

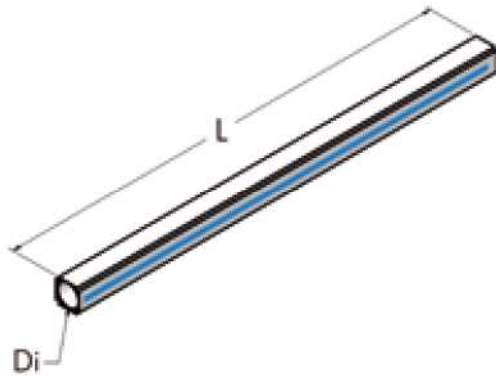

Di mm	L m	Part. no.	P kg	n°	
20	5	800 020 500	1,9	100	
25	5	800 025 500	3	64	
32	5	800 032 500	3,9	36	
40	5	800 040 500	5,8	36	
50	5	800 050 500	8,4	16	
63	5	800 063 500	10,4	16	

Di mm	L m	Part. no.	P kg	n°	
20	2,5	800 020 250	0,95	100	
25	2,5	800 025 250	1,5	64	
32	2,5	800 032 250	1,95	36	
40	2,5	800 040 250	2,9	36	
50	2,5	800 050 250	4,2	16	
63	2,5	800 063 250	5,2	16	

## ANODIZED ALUMINIUM EXTRUDED PIPE

POW

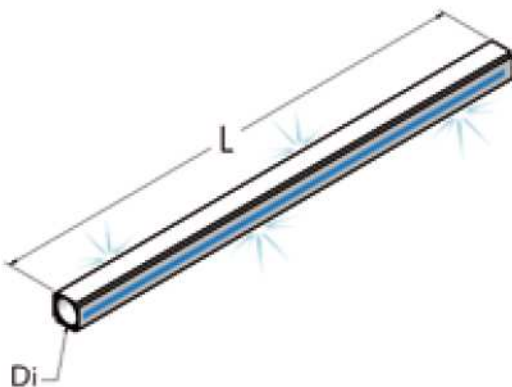

Di mm	L m	Part. no.	P kg	n°	
20	5	801 020 500	1,9	100	
25	5	801 025 500	3	64	
32	5	801 032 500	3,9	36	
40	5	801 040 500	5,8	36	
50	5	801 050 500	8,4	16	
63	5	801 063 500	10,4	16	

Di mm	L m	Part. no.	P kg	n°	
20	2,5	801 020 250	0,95	100	
25	2,5	801 025 250	1,5	64	
32	2,5	801 032 250	1,95	36	
40	2,5	801 040 250	2,9	36	
50	2,5	801 050 250	4,2	16	
63	2,5	801 063 250	5,2	16	

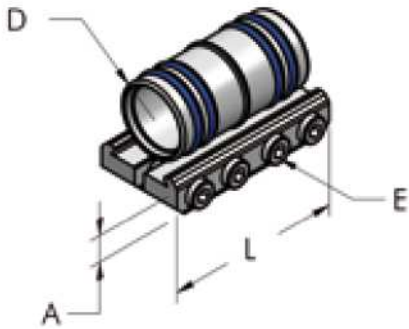
**STRAIGHT JOINT, COMPLETE****POW**

D mm	L mm	A mm	E mm	Part. no.	P g	n°	
20	46	9	4	006 020 020	39	10	
25	60	10	4	006 025 020	86	10	
32	95	11	4	006 032 020	170	10	
40	80	12	5	006 040 020	200	10	
50	150	12	5	006 050 020	395	10	
63	150	12	5	006 063 020	480	10	

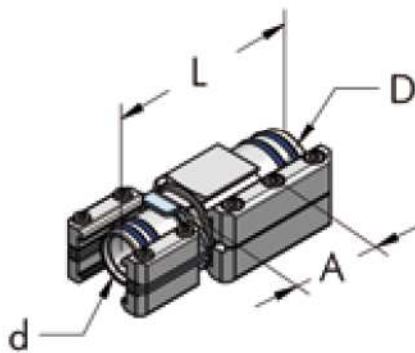
**REDUCTION STRAIGHT JOINT, COMPLETE**

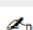
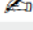
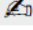
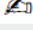
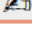
D mm	d mm	A mm	L mm	Part. no.	P g	n°	
25	20	55	100	006 025 051	170	5	
32	25	33	90	006 032 051	295	5	
40	32	55	120	006 040 051	495	5	
50	40	45	115	006 050 051	880	5	
63	50	15	90	006 063 051	1030	5	

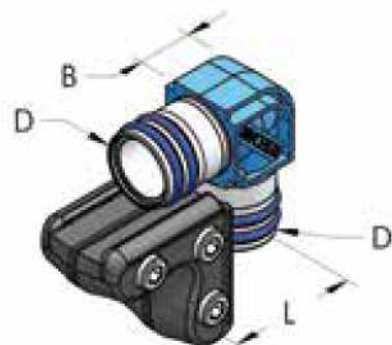
**L JOINT, COMPLETE**

D mm	L mm	B mm	Part. no.	P g	n°	
20	40	22	006 020 022	90	10	
25	50	30	006 025 022	135	10	
32	45	42	006 032 022	260	10	
40	75	50	006 040 022	430	10	
50	100	57	006 050 022	780	10	
63	100	72	006 063 022	910	10	

## T JOINT, COMPLETE

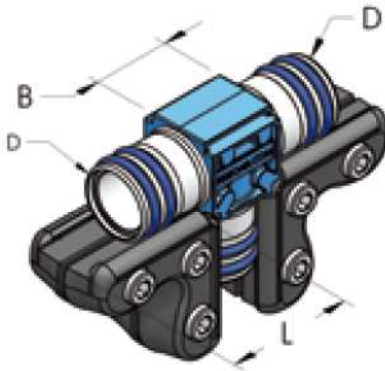

D mm	L mm	B mm	Part. no.	P g	n°	
20	40	24	006 020 024	150	10	
25	50	30	006 025 024	240	10	
32	45	50	006 032 024	430	10	
40	75	53	006 040 024	730	10	
50	100	60	006 050 024	1325	10	
63	100	76	006 063 024	1530	10	

## CLOSED TERMINAL, COMPLETE

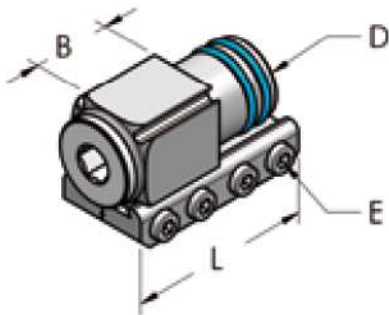

D mm	L mm	E mm	B mm	Part. no.	P g	n°	
20	46	4	24	006 020 026	70	10	
25	60	4	28	006 025 026	125	10	
32	46	4	30	006 032 026	220	10	
40	80	5	35	006 040 026	300	10	
50	150	5	75	006 050 026	710	10	
63	90	5	-	006 063 026	700	10	

## BALL VALVE, COMPLETE

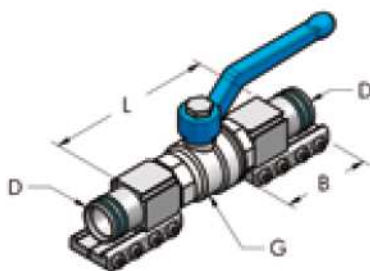



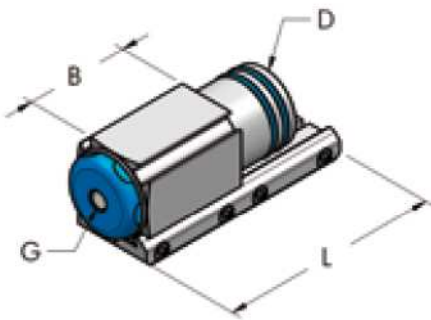

D mm	G	L mm	B mm	Part. no.	P g	n°	
20	1/2" - BSP	100	46	006 020 046	290	10	
25	3/4" - BSP	118	56	006 025 046	500	10	
32	1" - BSP	90	46	006 032 046	830	10	
40	1 1/4" - BSP	150	70	006 040 046	1250	10	
50	1 1/2" - BSP	245	150	006 050 046	2450	10	
63	2" - BSP	150	90	006 063 046	3300	10	

**TERMINAL WITH THREADED HOLE, COMPLETE**

POW

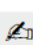

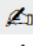
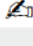
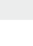

D mm	G	L mm	B mm	Part. no.	P g	n°	
32	1/4" - BSP	46	30	006 032 025	200	10	
32	1/2" - BSP	46	30	006 032 031	200	10	
40	1/8" - BSP	80	35	006 040 015	295	10	
40	1/4" - BSP	80	35	006 040 025	260	10	
40	3/8" - BSP	80	35	006 040 016	290	10	
40	1/2" - BSP	80	35	006 040 017	280	10	
40	3/4" - BSP	80	35	006 040 018	270	10	
50	1/8" - BSP	150	75	006 050 015	705	10	
50	1/4" - BSP	150	75	006 050 025	700	10	
50	1/2" - BSP	150	75	006 050 017	690	10	
50	3/4" - BSP	150	75	006 050 018	670	10	
50	1" - BSP	150	75	006 050 019	655	10	
63	1/4" - BSP	90	-	006 063 025	660	10	

**TERMINAL THREADED FEMALE, COMPLETE**

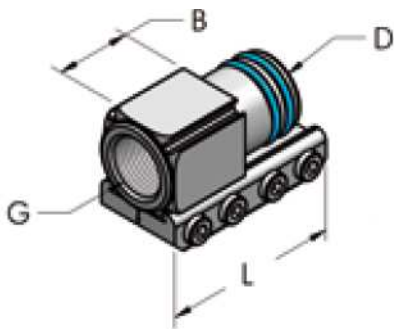
POW





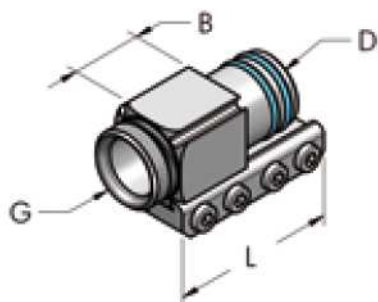

D mm	G	L mm	B mm	Part. no.	P g	n°	
20	3/8" - BSP	46	24	006 020 028	54	10	
25	1/2" - BSP	60	28	006 025 028	105	10	
32	1" - BSP	46	23	006 032 027	205	10	
40	1" - BSP	80	35	006 040 027	260	10	
50	1"1/4 - BSP	150	75	006 050 027	615	10	
50	1"1/2 - BSP	150	75	006 050 028	565	10	
63	1"1/2 - BSP	90	20	006 063 028	430	10	

**TERMINAL THREADED MALE, COMPLETE**

POW



D mm	G	L mm	B mm	Part. no.	P g	n°	
20	1/2" - BSP	46	24	006 020 030	57	10	
25	3/4" - BSP	60	28	006 025 030	110	10	
32	1" - BSP	46	11	006 032 030	200	10	
32	1"1/4 - BSP	46	13	006 032 029	255	10	
40	1"1/4 - BSP	80	35	006 040 029	245	10	
50	1"1/2 - BSP	150	75	006 050 029	655	10	
63	2" - BSP	90	12	006 063 030	390	10	
63	2"1/2 - BSP	90	13	006 063 031	450	10	



## FEMALE OUTLET PLATE, COMPLETE

POW

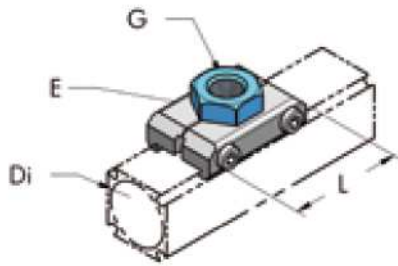

Di mm	G	L mm	E mm	Part. no.	P g	n°	
20	1/4" - BSP	46	22	006 020 033	36	10	
20	3/8" - BSP	46	22	006 020 034	40	10	
25	1/4" - BSP	46	22	006 025 033	37	10	
25	3/8" - BSP	46	22	006 025 034	46	10	
25	1/2" - BSP	46	30	006 025 035	55	10	
32	1/4" - BSP	50	30	006 032 033	70	10	
32	3/8" - BSP	50	30	006 032 034	65	10	
32	1/2" - BSP	50	30	006 032 035	70	10	
40	1/8" - BSP	70	36	006 040 032	148	10	
40	1/4" - BSP	70	36	006 040 033	140	10	
40	3/8" - BSP	70	36	006 040 034	135	10	
40	1/2" - BSP	70	36	006 040 035	130	10	
40	3/4" - BSP	70	36	006 040 036	120	10	
50/63	1/4" - BSP	74	50	006 050 033	195	10	
50/63	1/2" - BSP	74	50	006 050 034	190	10	
50/63	3/4" - BSP	74	50	006 050 035	215	10	
50/63	1" - BSP	74	50	006 050 036	195	10	

## MALE OUTLET PLATE, COMPLETE

POW

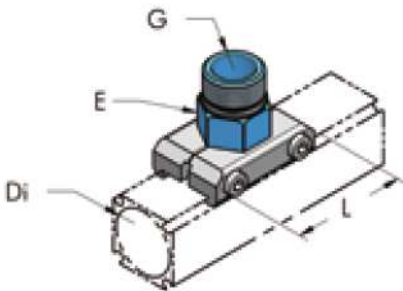





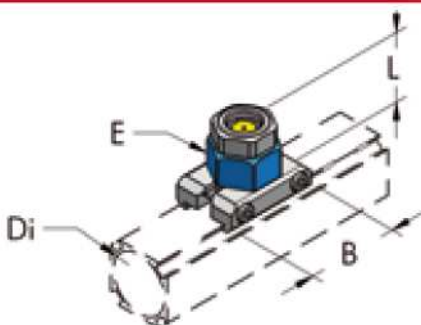



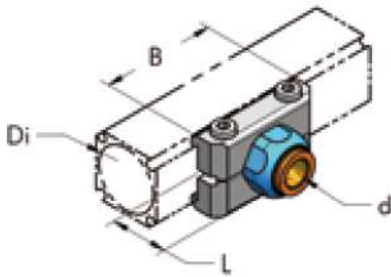

Di mm	G	L mm	E mm	Part. no.	P g	n°	
20	3/8" - BSP	46	22	006 020 063	36	10	
25	1/2" - BSP	46	22	006 025 064	49	10	
32	1/4" - BSP	50	30	006 032 064	75	10	
32	3/8" - BSP	50	30	006 032 065	75	10	
32	1/2" - BSP	50	30	006 032 066	74	10	
32	3/4" - BSP	50	30	006 032 067	72	10	
40	1/2" - BSP	70	36	006 040 062	135	10	
40	3/4" - BSP	70	36	006 040 063	140	10	
40	1" - BSP	70	36	006 040 064	140	10	
50/63	3/4" - BSP	74	50	006 050 063	190	10	
50/63	1" - BSP	74	50	006 050 064	185	10	
50/63	1"1/4" - BSP	74	50	006 050 065	190	10	
50/63	1"1/2" - BSP	74	50	006 050 066	195	10	

## CONDENSATE LEVEL SPY HOLE, COMPLETE







Di mm	L mm	B mm	E mm	Part. no.	P g	n°	
32	38	50	30	006 032 044	105	5	

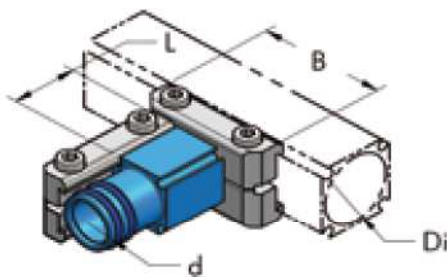



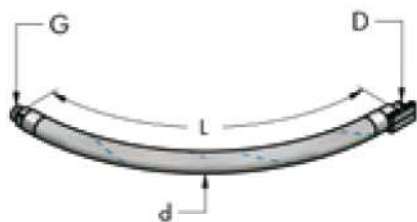

**OUTLET PLATE WITH QUICKFIT, COMPLETE**

Di mm	d mm	B mm	L mm	Part. no.	P g	n°	
20	8	46	23	006 020 084	112	10	
20	10	46	26	006 020 085	190	10	
25	8	46	23	006 025 084	235	10	
25	10	46	23	006 025 085	246	10	
32	8	50	30	006 032 084	80	10	
32	10	50	30	006 032 085	80	10	
32	12	50	30	006 032 086	80	10	
40	10	70	23	006 040 085	318	10	
40	12	70	26	006 040 086	370	10	







**REDUCTION PLATE, COMPLETE****POW**

Di mm	d mm	B mm	L mm	Part. no.	P g	n°	
25	20	46	24	006 020 039	112	10	
32	20	50	50	006 032 061	140	10	
32	25	50	42	006 032 062	155	10	
40	20	70	24	006 040 037	190	10	
40	25	70	28	006 040 038	235	10	
40	32	70	28	006 032 039	300	10	
50/63	20	74	35	006 050 038	318	10	
50/63	25	74	60	006 050 039	370	10	
50/63	32	74	28	006 032 060	370	10	
50/63	40	74	35	006 040 039	370	10	

**FLEXIBLE PIPE FOR CONNECTION TO COMPRESSOR FOR COMPRESSED AIR (15 BAR)**

D mm	G	L mm	d mm	Part. no.	P g	n°	
20	1/2" - BSP	700	30	006 020 058	500	1	
25	3/4" - BSP	700	35	006 025 058	750	1	
32	1"1/4 - BSP	1000	44	006 032 058	2000	1	
40	1"1/4 - BSP	1000	50	006 040 058	3000	1	
50	2" - BSP	1000	65	006 050 058	4075	1	
63	2"1/2 - BSP	1300	77	006 063 058	4700	1	

**FLEXIBLE JOINT FOR AP-AP CONNECTION FOR COMPRESSED AIR (15 BAR)**

D mm	M	L mm	d mm	Part. no.	P g	n°	
20	20	700	30	006 020 059	510	1	
25	25	700	35	006 025 059	830	1	
32	32	1000	44	006 032 059	2260	1	
40	40	1000	50	006 040 059	3050	1	
50	50	1000	65	006 050 059	4300	1	
63	63	1300	77	006 063 059	5000	1	

## MANOMETER, COMPLETE

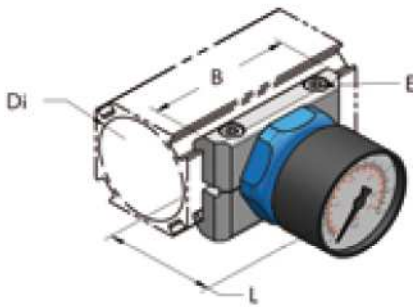

Di mm	L mm	B mm	E mm	Part. no.	P g	n°	
20	58	46	4	006 020 048	70	10	
25	52	56	4	006 025 048	75	10	
32	54	50	4	006 032 048	145	10	↙
40	58	70	5	006 040 048	174	10	
50/63	58	74	5	006 050 048	230	10	↙

## L PLATE, COMPLETE

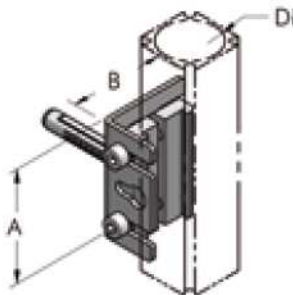

Di mm	d mm	A mm	B mm	Part. no.	P g	n°	
20	8	50	40	006 020 040	70	10	
25	8	50	40	006 025 040	75	10	
32	8	80	60	006 032 040	127	10	↙
40	8	80	60	006 040 040	140	10	
50/63	8	80	60	006 050 040	160	10	↙

## SNAP CLAMP, COMPLETE

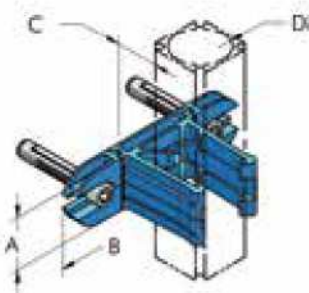

Di mm	A mm	B mm	C mm	Part. no.	P g	n°	
20	20	70	20	006 020 041	17	10	
25	25	88	17	006 025 041	25	10	
40	40	135	43	006 040 041	175	10	
50	50	150	40	006 050 041	213	10	

## SNAP CLAMP

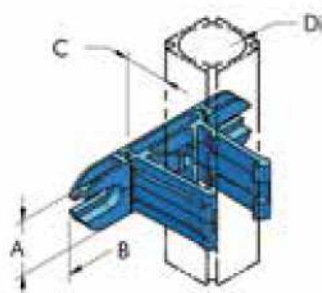

Di mm	A mm	B mm	C mm	Part. no.	P g	n°	
20	20	70	20	006 020 042	17	10	
25	25	88	17	006 025 042	25	10	
40	40	135	43	006 040 042	140	10	
50	50	150	40	006 050 042	174	10	

## HANGING BRACKET

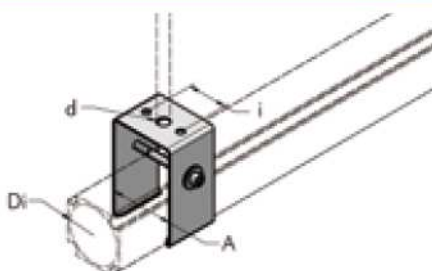



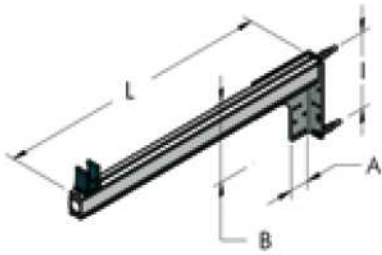

Di mm	A mm	d mm	i mm	Part. no.	P g	n°	
32	36	11	24	006 032 073	100	10	
40	45	11	30	006 040 073	274	10	
50	55	11	36	006 050 073	302	10	
63	69	11	36	006 063 073	323	10	

**SUPPORT BRACKET, COMPLETE**

POW



A mm	B mm	L mm	I mm	Part. no.	P g	n°	
136	174	600	140	006 020 070	1300	10	
136	174	600	140	006 025 070	1300	10	
136	174	600	140	006 040 070	1400	10	
136	174	600	140	006 050 070	1450	10	
136	174	600	140	006 063 070	1400	10	

**L PLATE IN GALVANIZED STEEL**

POW

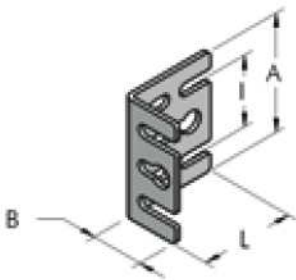

A mm	B mm	I mm	L mm	Part. no.	P g	n°	
50	25	30	40	732 020 050	37	10	
66	35	50	47	732 066 080	60	10	

**DRILLING JIG FOR AP22-AP28-AP45-AP54**

POW

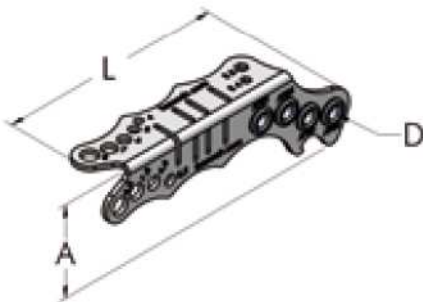

A mm	D mm	L mm	Part. no.	P g	n°	
45	6	136	911 020 050	90	1	

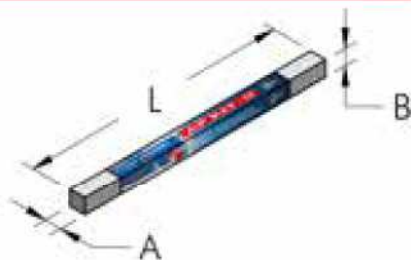
**MINI COMPRESSED AIR SYSTEM AP22 - 10m**

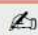
A mm	B mm	L m	Part. no.	P kg	n°	
125	125	2	006 022 102	5,6	1	

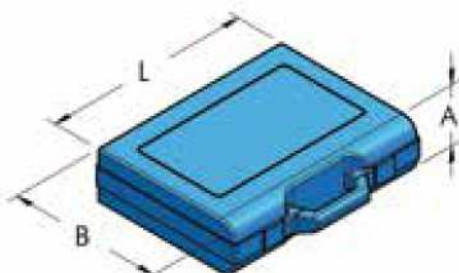
**BASIC TOOLS BOX**

A mm	B mm	L mm	Part. no.	P g	n°	
50	190	240	006 020 092	600	1	

## DEMO SUIT-CASE



A mm	B mm	L mm	Part. no.	P g	n°	
80	340	440	006 020 090	3700	1	

## MINI-DEMO SUIT CASE

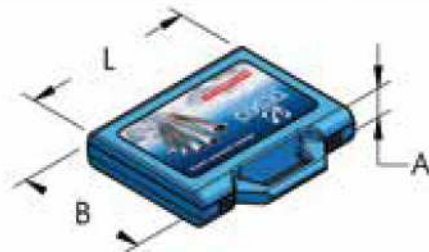

A mm	B mm	L mm	Part. no.	P g	n°	
50	190	240	006 020 091	550	1	

## BLUE PVC STRIP

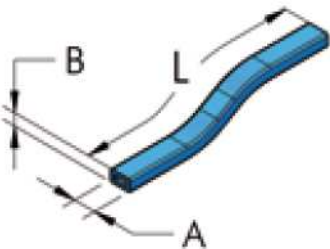

AP	L m	A mm	B mm	Part. no.	P g	n°	
45/54	1	10	5,8	874 010 100	58	100	
68	1	21	4,6	874 021 100	116	100	

## VASELINE GREASE

POW



Part. no.	P g	n°	
111 003 100	850	20	
111 003 010	100	20	

## PTFE BLUE GREASE

POW



Part. no.	P g	n°	
114 003 005	50	20	

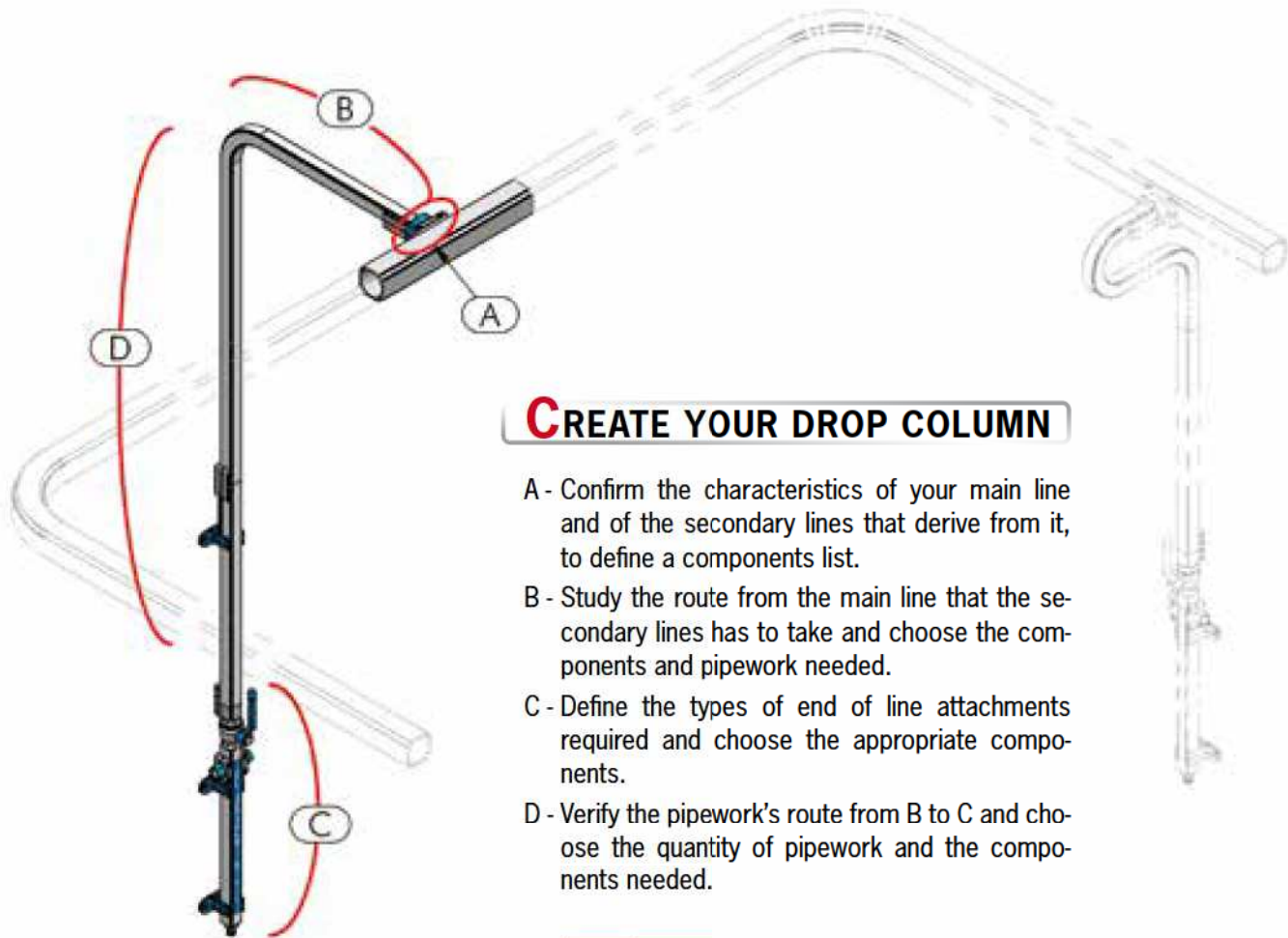





## CREATE YOUR DROP COLUMN

- A - Confirm the characteristics of your main line and of the secondary lines that derive from it, to define a components list.
- B - Study the route from the main line that the secondary lines has to take and choose the components and pipework needed.
- C - Define the types of end of line attachments required and choose the appropriate components.
- D - Verify the pipework's route from B to C and choose the quantity of pipework and the components needed.

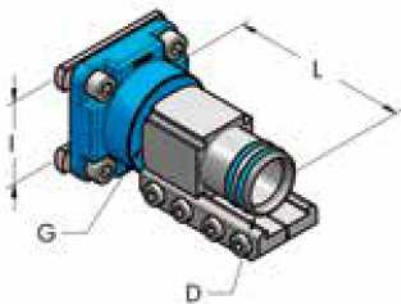
A	pages 47-48-49-55
B	pages 44-45-49-55-56
C	pages 44-45-46-47-48-50-55
D	pages 44-45

## REDUCTION PLATE HBS - AP, COMPLETE

D mm	G	I mm	L mm	Part. no.	P g	n°	
20	1/2" - BSP	36	49	006 020 037	180	1	
20	1/2" - BSP	60	54	006 020 038	190	1	
25	3/4" - BSP	36	49	006 025 037	310	1	
25	3/4" - BSP	60	54	006 025 038	340	1	
32	1" - BSP	36	37	006 032 037	305	1	
32	1" - BSP	60	42	006 032 038	435	1	
40	1"1/4 - BSP	60	70	006 040 060	750	1	
50	1"1/2 - BSP	60	105	006 050 037	820	1	
63	-	60	72	006 063 037	800	1	

## 2 OUTLETS BLOCK FOR AP DROP COLUMN

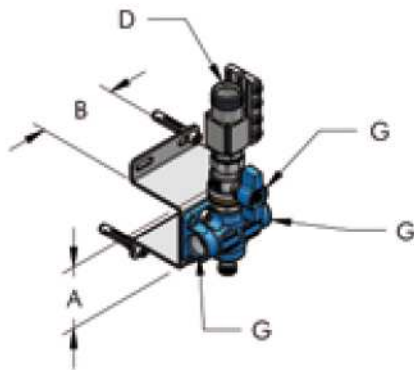

D mm	G	A mm	B mm	Part. no.	P g	n°	
20	1/2" - BSP	60	75	006 020 068	783	10	
20	1/2" - NPT	60	75	006 020 468*	783	10	
25	1/2" - BSP	60	75	006 025 068	865	10	
25	1/2" - NPT	60	75	006 025 468*	865	10	

\*G 1/4" - NPT, without condensate drain

## BENT PIPE FOR AP DROP COLUMN



Di mm	A mm	L mm	Part. no.	P g	n°	
20	40	500	804 020 040	257	10	
25	42	500	804 025 040	412	10	

## 2 OUTLETS BLOCK FOR AP DROP COLUMN WITH BENT PIPE



Di mm	G	A mm	B mm	L mm	Part. no.	P kg	n°	
20	1/2" - BSP	60	75	635	006 020 069	1,12	10	
20	1/2" - NPT	60	75	635	006 020 469*	1,12	10	
25	1/2" - BSP	60	75	635	006 025 069	1,36	10	
25	1/2" - NPT	60	75	635	006 025 469*	1,36	10	

\*G 1/4" - NPT, without condensate drain

## OUTLET PLATE WITH D14 QUICKFIT, COMPLETE

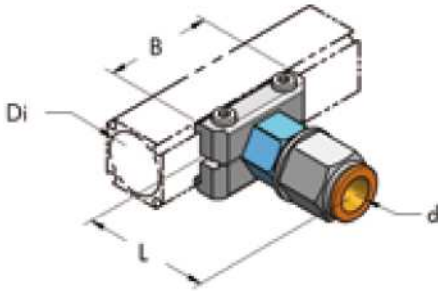

Di mm	d mm	B mm	L mm	Part. no.	P g	n°	
20	14	46	51	006 020 134	95	20	
25	14	56	52	006 025 134	100	20	
32	14	50	44	006 032 134	120	20	↗
40	14	70	50	006 040 134	190	20	
50/63	14	74	50	006 050 134	240	20	

## SPECIAL ANGLE CURVED PIPE

POW

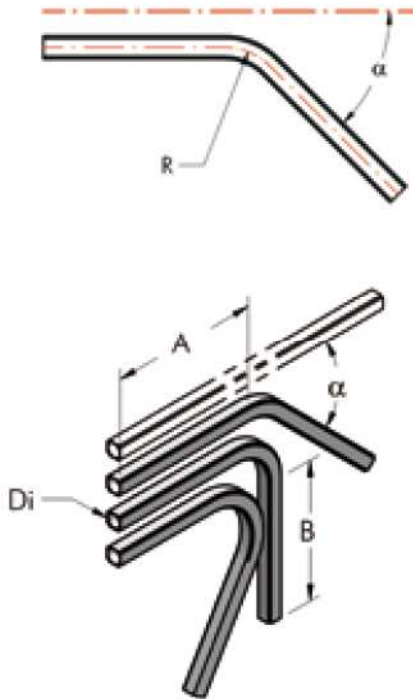

Di mm	A mm	B mm	R mm	$\alpha^\circ$	Part. no.	P Kg	n°	
20	220	240	77	30	804 020 047	0,2	5	↗
20	220	220	77	45	804 020 048	0,2	5	↗
20	220	200	77	60	804 020 049	0,2	5	↗
20	160	180	77	120	804 020 057	0,2	5	↗
20	160	160	77	135	804 020 058	0,2	5	↗
20	160	140	77	150	804 020 059	0,2	5	↗
25	220	240	77	30	804 025 047	0,3	5	↗
25	220	220	77	45	804 025 048	0,3	5	↗
25	220	200	77	60	804 025 049	0,3	5	↗
25	160	180	77	120	804 025 057	0,3	5	↗
25	160	160	77	135	804 025 058	0,3	5	↗
25	160	140	77	150	804 025 059	0,3	5	↗
32	160	260	150	30	804 032 047	0,6	5	↗
32	160	220	150	45	804 032 048	0,6	5	↗
32	160	180	150	60	804 032 049	0,6	5	↗
40	190	230	150	30	804 040 047	0,7	5	↗
40	190	190	150	45	804 040 048	0,7	5	↗
40	190	150	150	60	804 040 049	0,7	5	↗
50	160	260	150	30	804 050 047	1	5	↗
50	160	220	150	45	804 050 048	1	5	↗
50	160	180	150	60	804 050 049	1	5	↗
63	250	450	250	30	804 063 047	1,3	2	↗
63	250	385	250	45	804 063 048	1,3	2	↗
63	250	320	250	60	804 063 049	1,3	2	↗

## DROP COLUMN MANIFOLD COMPLETE WITH ACCESSORIES

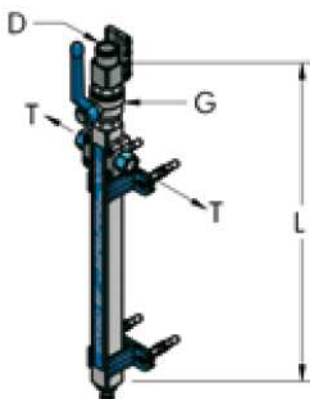

D mm	L mm	G	T	Part. no.	P g	n°	
20	440	1/2" - BSP	3/8" - BSP	006 020 055	680	1	
25	440	3/4" - BSP	3/8" - BSP	006 025 055	1060	1	



## 90° CURVED PIPE

POW

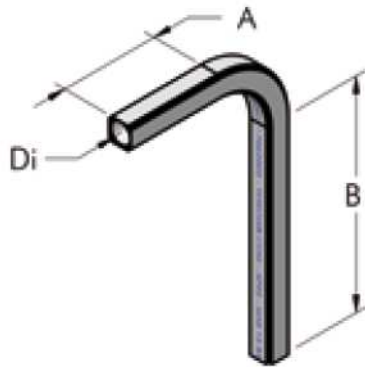

Di mm	A mm	B mm	R mm	Part. no.	P Kg	n°	
20	80	300	77	804 020 050	0,2	5	
20	310	570	77	804 020 100	0,4	5	
20	370	2010	77	804 020 250	0,9	5	
25	115	250	77	804 025 050	0,3	5	
25	310	570	77	804 025 100	0,6	5	
25	370	2010	77	804 025 250	1,5	5	
32	135	255	150	804 032 050	0,8	5	
40	135	255	150	804 040 050	1	5	
50	160	230	150	804 050 050	1,05	5	
63	250	360	250	804 063 050	1,3	5	

## 180° CURVED PIPE

POW

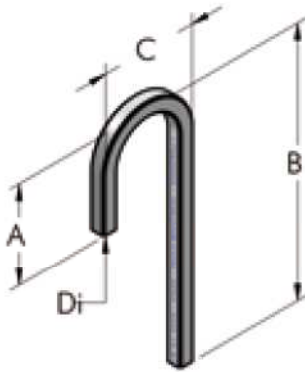

Di mm	A mm	B mm	C mm	Part. no.	P Kg	n°	
20	190	496	176	804 020 060	0,25	5	
20	180	1255	176	804 020 149	0,55	5	
25	200	490	182	804 025 060	0,4	5	
25	200	1240	182	804 025 149	0,9	5	

## 180°-90° CURVED PIPE

POW

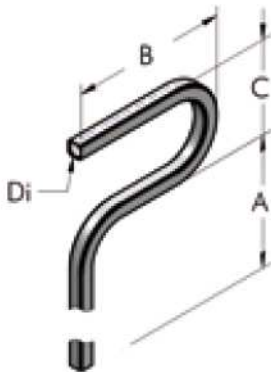

Di mm	A mm	B mm	C mm	R mm	Part. no.	P Kg	n°	
20	1375	296	176	77	804 020 148	0,95	5	
25	1370	302	182	77	804 025 148	1,5	5	

## 4 HOLES FEMALE OUTLET PLATE, COMPLETE

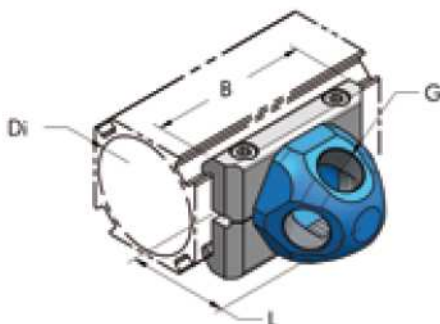

Di mm	B mm	L mm	G	Part. no.	P g	n°	
50/63	74	47	3/8" - BSP	006 050 053	200	10	
50/63	74	47	1/2" - BSP	006 050 054	190	10	

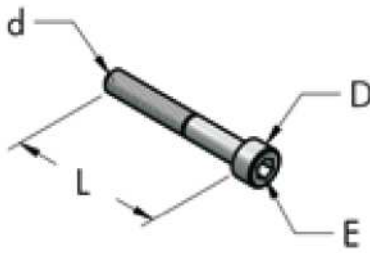
**ALLEN SCREW, IN GALVANIZED STEEL**

d mm	L mm	D mm	E mm	Part. no.	P g	n°
M5	20	8,5	4	212 005 020	4	20
M5	25	8,5	4	212 005 025	5	20
M5	30	8,5	4	212 005 030	5,5	20
M6	35	10	5	212 006 035	9	20
M6	45	10	5	212 006 045	14	20
M6	55	10	5	212 006 055	14	20

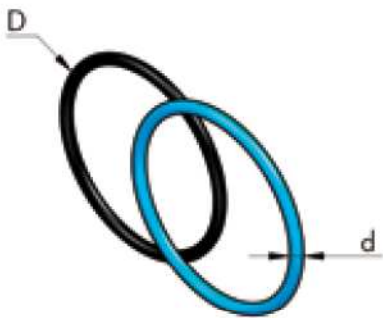
**O-RING SEAL IN NBR70**

D mm	d mm	Code AS/BS NORM	Part. no.	P g	n°
16	1,78	2050-014	271 012 002	0,1	10
16	2	0120-02	271 013 002	0,2	100
20	1,78	2062-014	271 016 002	0,15	10
20	2	0160-02	271 017 002	0,2	100
25	1,78	2081-019	271 020 002	0,22	10
25	2	0210-02	271 021 002	0,8	100
25	2,62	3087-118	271 022 003	0,5	100
36	3	0300-03	271 031 003	0,9	100
40	3	0350-03	271 035 003	1,1	10
50	2,62	3175-132	271 044 003	1	10
50	3	0440-03	271 043 003	1,3	100

**15 BAR ADHESIVE COLOUR STICKERS**

HBS

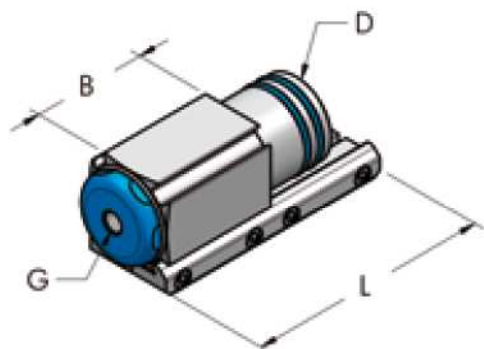

L mm	B mm	Colour	Part. no.	P g	n°
310	15	Blue RAL 5015	104 015 310	29	11
310	15	Green RAL 6029	104 015 315	29	11
310	15	Brown RAL 8003	104 015 316	29	11
310	15	Grey RAL 7000	104 015 317	29	11
310	15	Red RAL 3020	104 015 318	29	11
310	15	Yellow RAL 1028	104 015 319	29	11
310	28	Blue RAL 5015	104 025 150	29	11
310	28	Green RAL 6029	104 028 315	29	11
310	28	Brown RAL 8003	104 028 316	29	11
310	28	Grey RAL 7000	104 028 317	29	11
310	28	Red RAL 3020	104 028 318	29	11
310	28	Yellow RAL 1028	104 028 319	29	11

**TERMINAL WITH NPT THREADED HOLE, COMPLETE**
**POW**

D mm	G	L mm	B mm	Part. no.	P g	n°	
32	1/4" - NPT	46	30	006 032 425	200	10	
32	1/2" - NPT	46	30	006 032 431	195	10	
40	1/8" - NPT	80	35	006 040 415	295	10	
40	1/4" - NPT	80	35	006 040 425	260	10	
40	3/8" - NPT	80	35	006 040 416	290	10	
40	1/2" - NPT	80	35	006 040 417	280	10	
40	3/4" - NPT	80	35	006 040 418	270	10	
50	1/8" - NPT	150	75	006 050 415	705	10	
50	1/4" - NPT	150	75	006 050 425	700	10	
50	1/2" - NPT	150	75	006 050 417	690	10	
50	3/4" - NPT	150	75	006 050 418	670	10	
50	1" - NPT	150	75	006 050 419	655	10	
63	1/4" - NPT	90	-	006 063 425	660	10	

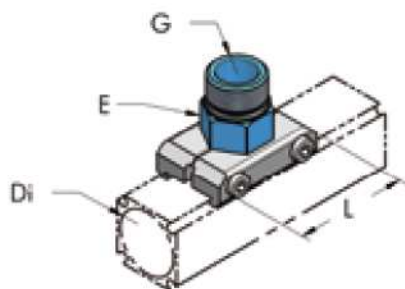
**NPT MALE OUTLET PLATE, COMPLETE**
**POW**

Di mm	G	L mm	E mm	Part. no.	P g	n°	
20	3/8" - NPT	46	22	006 020 463	36	10	
25	1/2" - NPT	46	22	006 025 464	49	10	
32	1/4" - NPT	30	50	006 032 464	75	10	
32	3/8" - NPT	30	50	006 032 465	75	10	
32	1/2" - NPT	30	50	006 032 466	74	10	
32	3/4" - NPT	30	50	006 032 467	72	10	
40	1/2" - NPT	70	36	006 040 462	135	10	
40	3/4" - NPT	70	36	006 040 463	140	10	
40	1" - NPT	70	36	006 040 464	140	10	
50/63	3/4" - NPT	74	50	006 050 463	190	10	
50/63	1" - NPT	74	50	006 050 464	185	10	
50/63	1 1/4" - NPT	74	50	006 050 465	190	10	
50/63	1 1/2" - NPT	74	50	006 050 466	195	10	

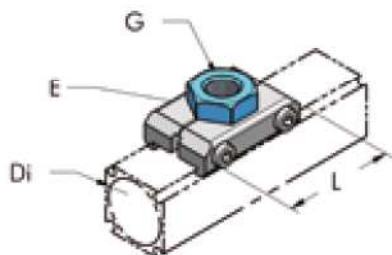
**NPT FEMALE OUTLET PLATE, COMPLETE**
**POW**

Di mm	G	L mm	E mm	Part. no.	P g	n°	
20	1/4" - NPT	46	22	006 020 433	36	10	
20	3/8" - NPT	46	22	006 020 434	40	10	
25	1/4" - NPT	46	22	006 025 433	37	10	
25	3/8" - NPT	46	22	006 025 434	46	10	
25	1/2" - NPT	46	30	006 025 435	55	10	
32	1/4" - NPT	50	30	006 032 433	70	10	
32	3/8" - NPT	50	30	006 032 434	65	10	
32	1/2" - NPT	50	30	006 032 435	70	10	
40	1/8" - NPT	70	36	006 040 432	148	10	
40	1/4" - NPT	70	36	006 040 433	140	10	
40	3/8" - NPT	70	36	006 040 434	135	10	
40	1/2" - NPT	70	36	006 040 435	130	10	
40	3/4" - NPT	70	36	006 040 436	120	10	
50/63	1/4" - NPT	74	50	006 050 433	195	10	
50/63	1/2" - NPT	74	50	006 050 434	190	10	
50/63	3/4" - NPT	74	50	006 050 435	215	10	
50/63	1" - NPT	74	50	006 050 436	195	10	

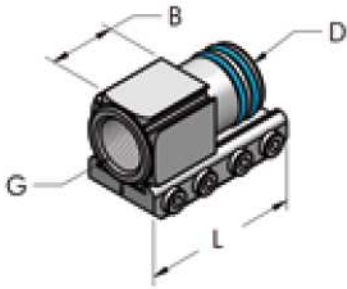
**NPT FEMALE THREADED TERMINAL, COMPLETE**
**POW**

D mm	G	L mm	B mm	Part. no.	P g	n°	
20	3/8" - NPT	46	24	006 020 428	54	10	
25	1/2" - NPT	60	28	006 025 428	105	10	
32	1" - NPT	46	23	006 032 427	205	10	↙
40	1" - NPT	80	35	006 040 427	260	10	↙
50	1"1/4" - NPT	150	75	006 050 427	615	10	↙
50	1"1/2" - NPT	150	75	006 050 428	565	10	↙
63	1"1/2" - NPT	90	20	006 063 428	430	10	↙

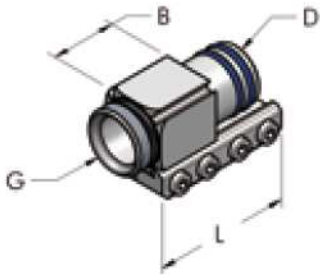
**NPT MALE THREADED TERMINAL, COMPLETE**
**POW**

D mm	G	L mm	B mm	Part. no.	P g	n°	
20	1/2" - NPT	46	24	006 020 430	57	10	
25	3/4" - NPT	60	28	006 025 430	110	10	
32	1" - NPT	46	11	006 032 430	200	10	↙
32	1"1/4" - NPT	46	13	006 032 429	255	10	↙
40	1"1/4" - NPT	80	35	006 040 429	245	10	
50	1"1/2" - NPT	150	75	006 050 429	655	10	
63	2" - NPT	90	12	006 063 430	390	10	↙
63	2"1/2" - NPT	90	13	006 063 431	450	10	↙

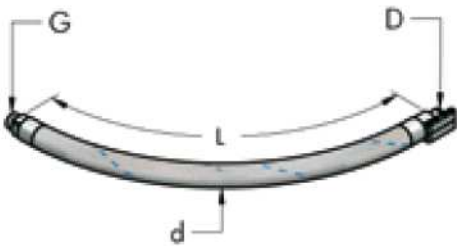
**FLEXIBLE PIPE WITH THREADED TERMINAL FOR CONNECTION TO COMPRESSOR FOR COMPRESSED AIR (15 BAR)**

D mm	G	L mm	d mm	Part. no.	P g	n°	
20	1/2" - NPT	700	30	006 020 458	500	1	↙
25	3/4" - NPT	700	35	006 025 458	750	1	↙
32	1"1/4" - NPT	1000	44	006 032 458	2000	1	↙
40	1"1/4" - NPT	1000	50	006 040 458	3000	1	↙
50	2" - NPT	1000	65	006 050 458	4075	1	↙
63	2"1/2" - NPT	1300	77	006 063 458	4700	1	↙

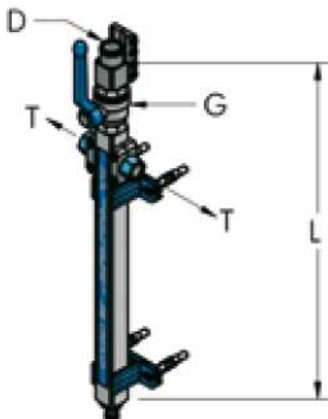
**DROP COLUMN MANIFOLD WITH NPT FEMALE THREADED OUTLETS**

D mm	L mm	G	T	Part. no.	P g	n°	
20	440	1/2" - BSP	3/8" - NPT	006 020 455	680	1	↙
25	440	3/4" - BSP	3/8" - NPT	006 025 455	1060	1	↙